



APPENDIX 2

Govan Area Partnership

Report by: Area Roads Technician, Neighbourhoods Regeneration and Sustainability



The Neighbourhood Infrastructure Improvement Fund (NIIF) – Progress Update

Purpose of Report:
To provide the Area Partnership with a breakdown of Govan Road possible resurfacing locations which may wish to be funded through NIIF. With the use of mapping and analysed data of the roads condition this aims to provide a clear breakdown of locations and costs throughout its extents.

Recommendations:
The Area Partnership is asked to note the contents of the report, review the content provided, confirm a decision on any areas they wish to progress through NIIF.

report.

Summary

This report has been prepared to provide a visual overview and an estimated cost for areas of resurfacing along Govan Road, should the Area Partnership wish to progress these works through the NIIF.

Should any of these works be approved by the Area Partnership, they would compliment the significant roads investment within the Greater Govan Ward already established by NRS Roads within fiscal years 25/26 & 26/27.

Govan Road, which falls within both the Govan East Community Council and the Central Govan Community Council areas, has been divided into nine sections. Each section sets out the extent of the proposed works, indicating the start and end points, along with indicative costs.

The estimates provided are based on a treatment consisting of a 60mm carriageway inlay. Please note that all costs are indicative at this stage.

A 60 mm inlay carriageway resurfacing is a road repair method where the top 60 millimetres (about 6 cm) of the existing road surface is removed and replaced with new asphalt. Deeper patching of the carriageway layers may be required at certain points depending on the nature of the carriageway defects. The worn or damaged surface layer is first milled off using specialised machinery, and then a new layer of asphalt of the same thickness is laid in its place. This process improves the smoothness, grip, and overall condition of the road while keeping the road level the same, which avoids affecting kerbs, drainage, and nearby surfaces. It is a common and cost-effective way to extend the life of a road without needing to fully rebuild it.

Section 1. – Govan Road, Harvie Street to Pacific Drive



Section 2. – Govan Road, Pacific Drive to Merryland Street



Section 3. – Govan Road, Merryland Street to Canting Way



Section 4. – Govan Road, Canting Way to Burndyke Court

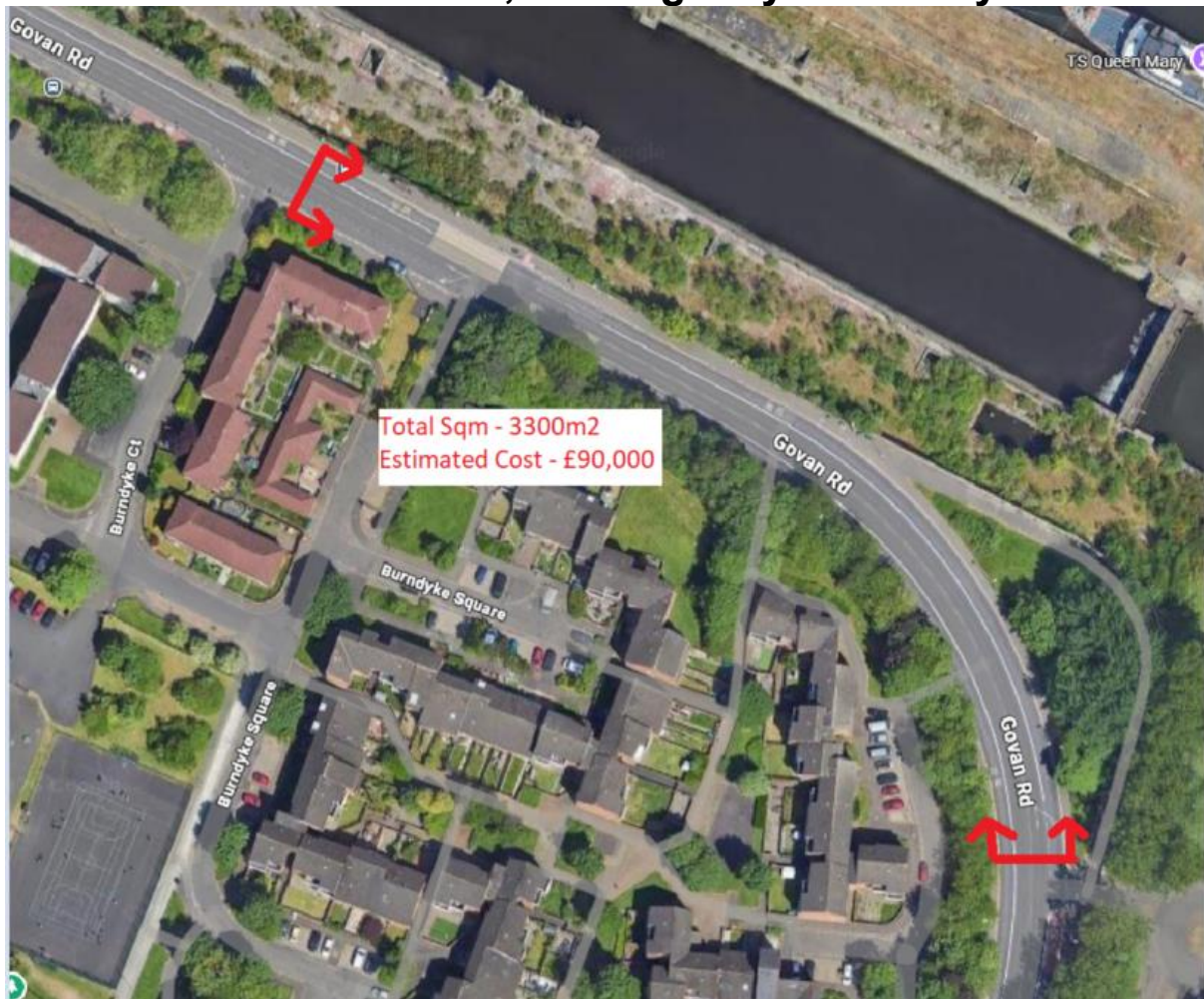

Section 5. – Govan Road, Burndyke Court to Southcroft Street



Section 6. – Govan Road, Southcroft Street to Orkney Street



Section 7. – Govan Road, Orkney Street to No.788 (Dental Practice)

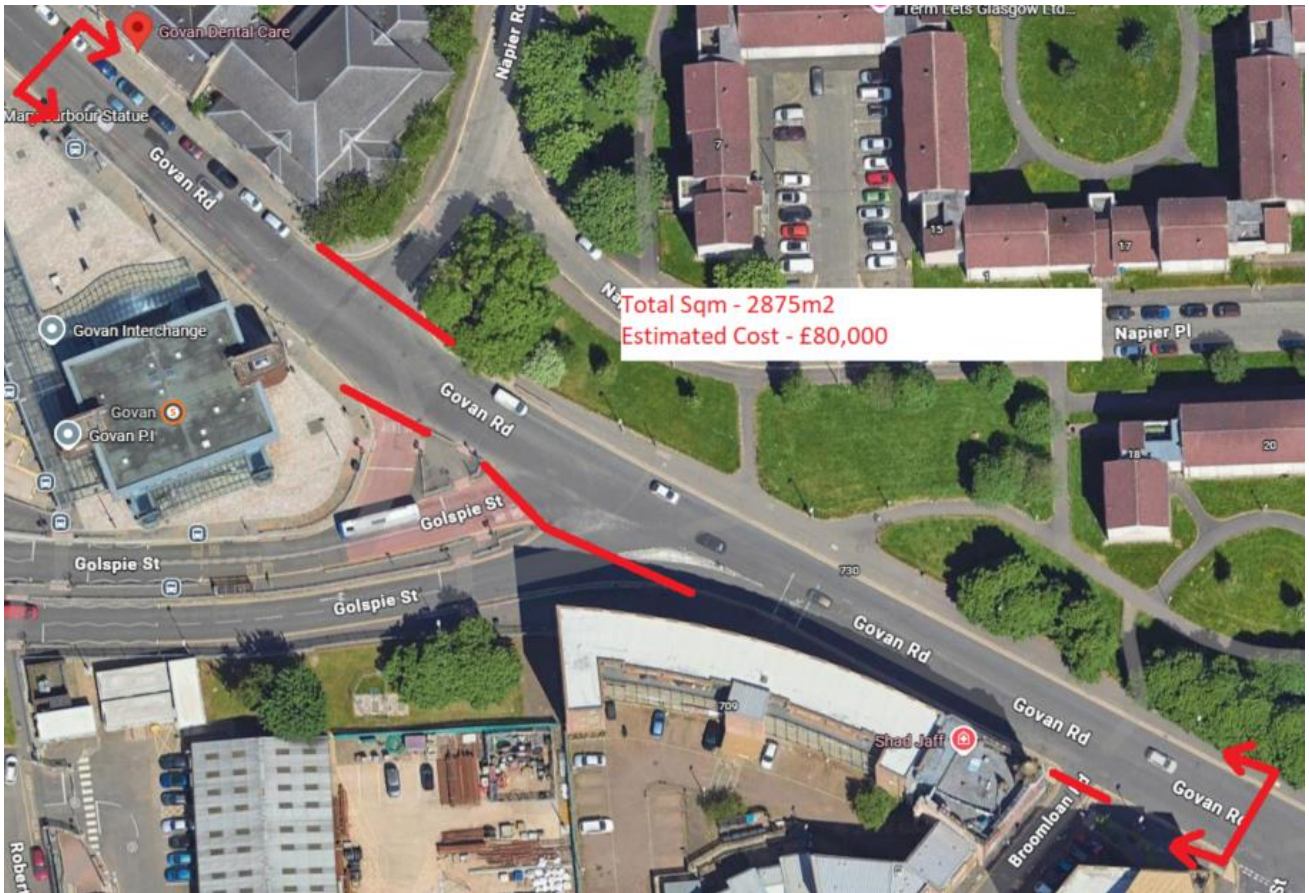

Section 8. – Govan Road, Water Row to Constantine Lane



Section 9. – Govan Road, Harmony Row to Howat Street

